

# Lohsepark, Hamburg

The competition for Hamburg Hafen City is one of many projects to define a contemporary urban landscape signature of this dynamic new neighbourhood. The objectives were varied and challenging; ranging from urban piazzas, a cultural centre & elementary school, park areas at the north & south water edges. Last, define a commemorative space at the east of the parc with the remnants of the rail tracks, vestiges of the deportation from Hamburg

during WWII. This was to connect to the west side of the park, where will stand the future museum dedicated to this historical period.

Using 3D modelling tools resolved complex topographic issues and aided in the définition of scenographic promenades across the park's various leisure areas. To buffer the park from the intense traffic boulevard at the south, a large hill was cre-

ated, which on its south slope provides a series of seated areas with a panoramic view of the water and Hafen. The planting strategy was to use dense plantations of gleditsia, pine and linden trees on the edges of the park and maintain several green mews as spaces to be adapted for recreational and cultural needs. The lighting concept underlines the small retaining walls / benches as well as the paths acting as ribbons in this quadratric urban typology.

## Selected Projects

**Design:**  
Christophe Girot  
Atelier Girot GmbH

**Surface:**  
5 ha

**Dates:**  
Competition 2009  
Competition 2<sup>d</sup> round 2010

**Client:**  
Hafencity Hamburg GmbH

**Budget:**  
10 million Euros

**Competition:**  
2<sup>d</sup> round



1



2

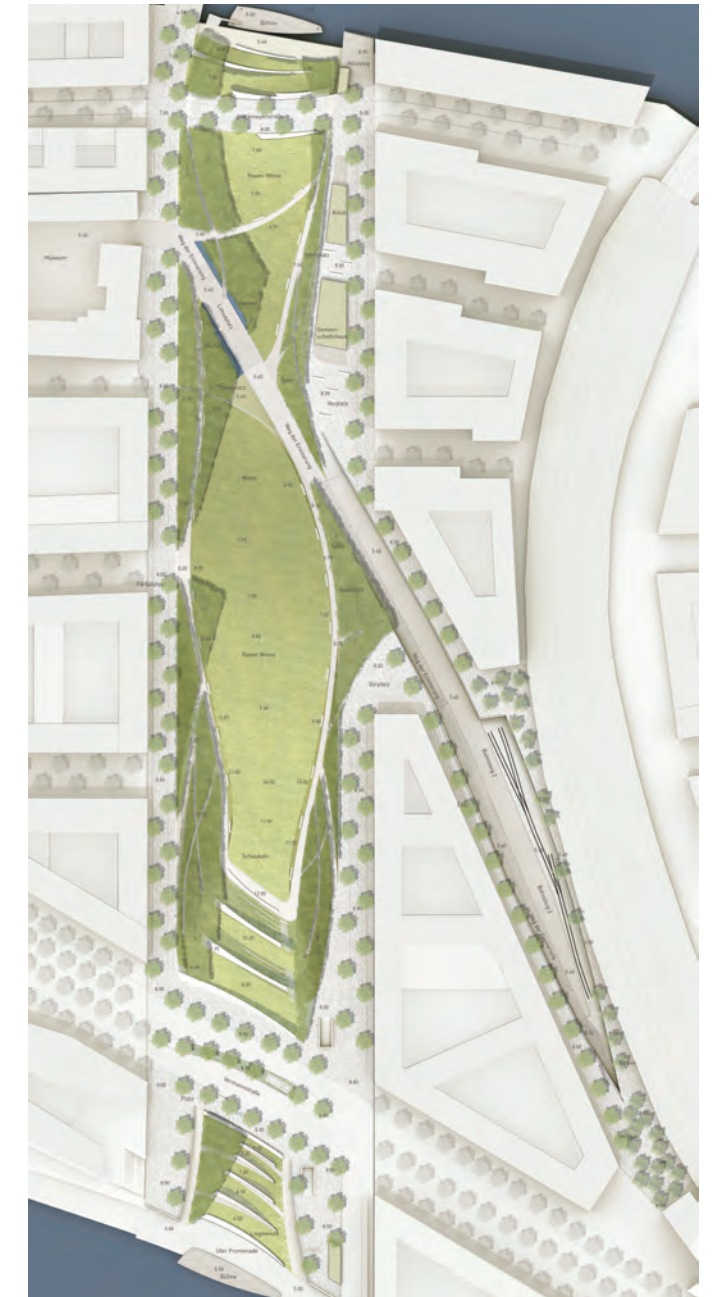

4

- 1 View of the park from the top of the hill
- 2 West-East section across the park
- 3 3D sequence study
- 4 Masterplan