

Parco Castello di Firenze, Firenze

The Parco Castello di Firenze is the largest park project to be planned in Florence this century. The 80 hectare park, abutting a new city quarter, is located at the fringe of the airport. The park proposes a network of 15 kilometres of waterways, drainage ditches and reservoirs, 10 kilometres of bicycle tracks, and 20 kilometres of pedestrian and equestrian paths. The park planted with over 5 000 trees will serve a new “ecological” neigh-

bourhood of 1 million square meters integrating, two new tramway lines. Historically the water collecting zone of the area, the parc has to manage different water levels scenarios throughout the season. Using the existing networks of fine drainage system as a digital base for the structure of the design, the park is composed of a series of landscape cells, which can act as floodwater retaining system for the

new city district. 3D models were made to anticipate water flow and insure usability of the park as well as fostering ecological zones within the public park program. Each cell in the park is developed as a distinct centre of activity. It will harbour the new seats of the Regional Government of Tuscany as well as that of the Province of Florence.

Selected Projects

Design:
Christophe Girot
Atelier Girot GmbH

Surface:
80 ha

Client:
Europrogetti, La Fundiaria
City of Florence

Dates:
Study 2005-2009

Project Phase:
Design Construction

Budget:
32 million Euros

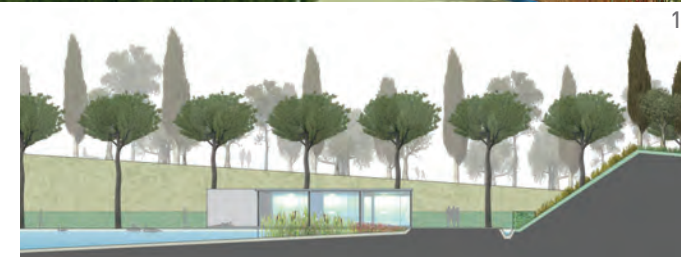
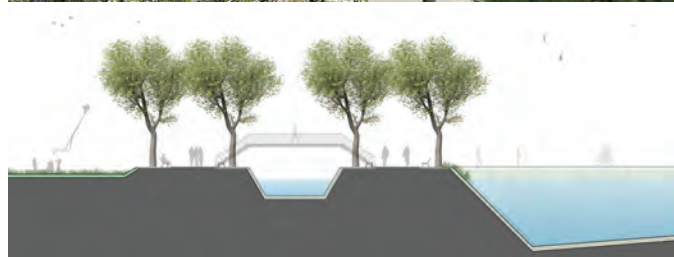
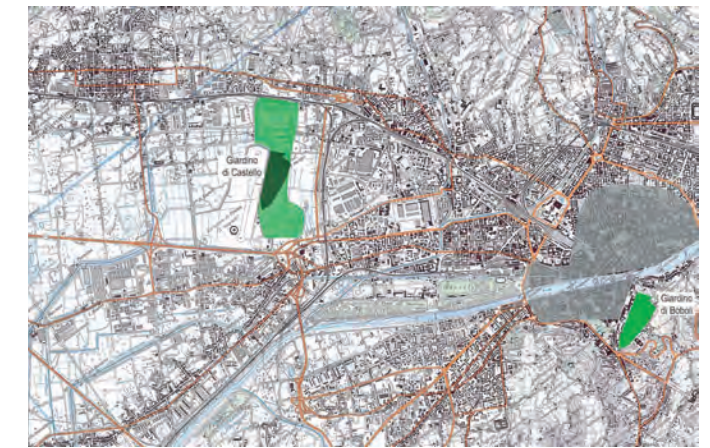
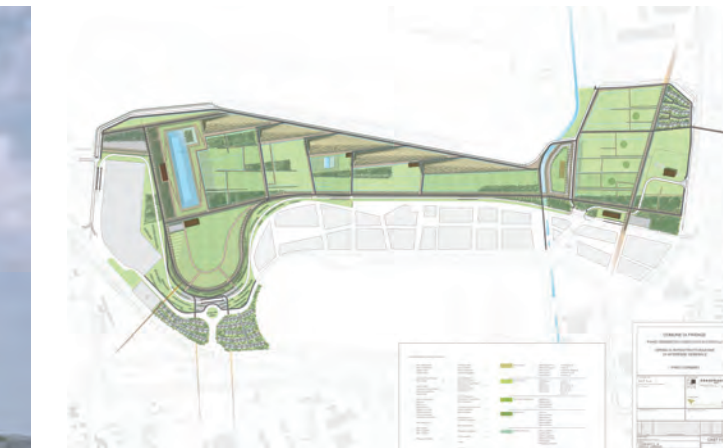

- 1 View of the Park
- 2 Section ecological Pool
- 3 Master Plan
- 4 Location within Florence
- 5 Views of the Park
- 6-7 Section canal and bassin
- 8 Section pavillon of the Arts